



# KUMUKAHI

## HEALTH + WELLNESS

**Board of Directors** September 26, 2024

Larry McGoff  
*President*

Molly O'Quinn  
*Vice President*

Keith Brown  
*Treasurer*

Jennifer Rabideau  
*Secretary*

Jenifer Aaronson, MD

Elena Cabatu

Lee-Ann Heely, M. Ed., DM

Emily Malate, LCSW

Luahiwa Namahoe

Martin Rathbun

Nicholas VandenRaadt, RN BSN

**Chief Executive Officer**

Peter Tuiolosega Silva

Dear community supporter,

Kumukahi Health + Wellness has been serving the island of Hawai'i for over 40 years. We are a 501c3 dedicated to ending health disparities on our island and providing equitable health care access to some of the most vulnerable and most rural residents across the state, especially those living with the HIV and the LGBTQ+ community.

Kumukahi Health + Wellness is made up of 4 core programs to improve health care for our community:

1. HIV Client Services – assisting our clients living with HIV to access free or affordable medical and specialty care, provide equitable access to very expensive medications, assistance in housing and addressing food insecurity.
2. Harm Reduction Services – providing access to sexual health screenings, linkages to medical care, educating our community and youth, and meeting our clients where they are at to provide Harm Reduction materials to keep them and our community safe.
3. Kokua Med-QUEST Program – providing government medical insurance navigation to our Native Hawaiian and Pacific Islander communities, farm workers, immigrants, and the unsheltered community.
4. Aiaola Sexual Health Clinic – providing medical services for people living with HIV or treatment for hepatitis C, LGBTQ+ health

This year we are seeking the support of our Kona Office Expansion. Our new office will provide 2 new clinic and counseling spaces, a wellness room, 4 program offices, a syringe exchange room, a kitchen and food pantry, and also more space for having our clients come in for lunch and wellness activities, such as hula and yoga.

We are asking folks for monetary or in-kind donations to help bring this vision to life. As most donation have gone to the Maui wildfires over the past year (and rightly so), we have had a very difficult time in fundraising activities. Therefore, any help you can provide to make this space loving and welcoming to our West Hawai'i community is most appreciated!

**East Hawai'i Office**  
101 Aupuni Street, PH 1014C  
Hilo, HI 96720  
Phone: 808-982-8800  
Fax: 808-982-8802

**West Hawai'i Office**  
74-5620 Palani Road  
Suite 101  
Kailua-Kona, HI 96740  
Phone: 808-331-8177  
Fax: 808-331-0762

[kumukahiHEALTH.org](http://kumukahiHEALTH.org)

A NEW DAY FOR H.I.H.A.F.



# KUMUKAHI

HEALTH + WELLNESS

Checks can be made to:

Kumukahi Health + Wellness  
101 Aupuni St., Suite 1014-C  
Hilo, Hawai'i 96720  
Attn: Cindy Medeiros

Physical items can be shipped to:

Kumukahi Health + Wellness  
74-5620 Palani Rd., Suite 207  
Kailua-Kona, HI 96740  
(808) 331-8177

Please feel free to contact me at (808) 982-8800 or by email [psilva@kumukahihealth.org](mailto:psilva@kumukahihealth.org).

All the best,

Peter T. Silva  
CEO  
Kumukahi Health + Wellness

EXISTING WALL (TYP)  
CLINIC ROOM #2

(E) 3-0" SWING DOOR

NEW ELECTRIC ON-DEMAND WATER HEATER BELOW

MICIN

ELEC



**KUMUKAHI**  
HEALTH + WELLNESS

# Movin' on Up!



## Help us get out of the Conference Room!

We are bustin' at the seams in our Kona office, so much so, that we have staff working out of our Conference Room!

Our office renovation in Hilo was such a success, we're doing it now in Kona. YOU can help!

Scan to Donate



or Visit



*Sponsorship Levels\**  
with tiered benefits!

**TITANIUM Hammer**  
\$20,000+

**PLATINUM Hammer**  
\$10,000+

**GOLD Hammer**  
\$5,000+

**SILVER Hammer**  
\$1,000+

**TURQUOISE Hammer**  
\$500+

**GLITTER Hammer**  
\$100+

\*5% of your donation is applied toward administrative costs

[kumukahiHEALTH.org/#donate](http://kumukahiHEALTH.org/#donate)



REVISIONS	BY
▲ CORRECTIONS 9/5/23	PJP

**PIPER  
DESIGNS**

Pete Piper  
808-331-2244  
75-5944 Kuakini Hwy, Ste 2  
Kailua Kona, HI 96740

JEFFREY L. GROSS  
LICENSED  
PROFESSIONAL  
ARCHITECT  
AR 11532  
HAWAII U.S.A.

EXPIRES 04/30/2026

This work was prepared by me or under my supervision and construction of this project will be under my observation.

Signature

TENANT INTERIOR ALTERATIONS FOR:  
**KUMUKAHI HEALTH + WELLNESS**  
PALANI COURT UNIT 207, KAILUA KONA, HAWAII  
T.M.K. (3) 7-4-010:038

DRAWN : PJP	JOB # : P22-044
DATE : 5/8/2023	
SCALE : 1/4"=1'-0"	
DRAWING: PROPOSED FLOOR PLAN	
SHEET	
<b>A03</b>	
6 OF 12 SHEETS	

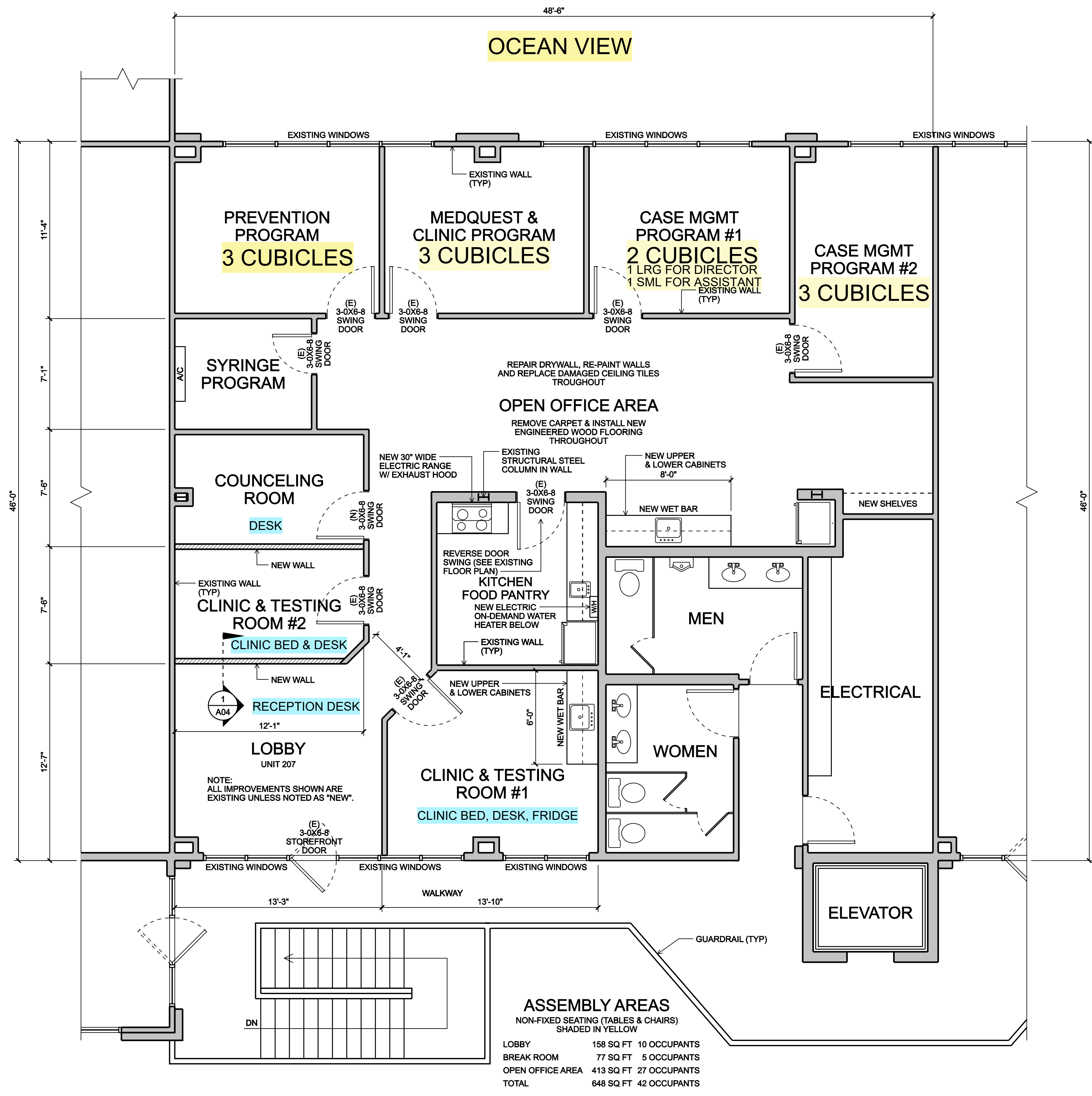

**PROPOSED FLOOR PLAN**

